



# **Denali PLOW MOUNT**

## **MA11745**

### **CanAm Commander**

Thank you for purchasing our Denali plow mount(s). You now own a premium, custom plow mount to allow you to use your plow with your SxS. Please note the following instructions and heed all warnings.

- Your UTV/SxS and/or plow system can cause death or injury, please use caution and common sense when operating your unit.
- Read your Plow Operator's Manual, your Winch Operator's Manual, and all warning labels before operating your UTV/SxS.
- Operate your SxS at a walking speed with the blade installed. Do not exceed 5 mph (8 km/h) even with the blade up.
- Do not operate the UTV/SxS on slopes greater than 10 degrees with the plow installed.
- Always lower the plow to the down position before leaving your UTV/SxS unattended.

**SEVERE INJURY OR DEATH MAY RESULT IF YOU ARE NEGLIGENT.**

Please verify that all hardware and parts are included in your package.

Kit Content: Please refer to Figure 1

Item	Qty	Description
1	1	MA11745 Plow Mount
2	4	5/16" Nylock Nut
3	8	5/16" Washer
4	2	3/8" x 1 1/4" HH G5 Bolt
5	2	3/8" Nylock Nut
6	4	3/8" Flat Washers
7	4	5/16" x 3 3/4" HH G5 Bolt

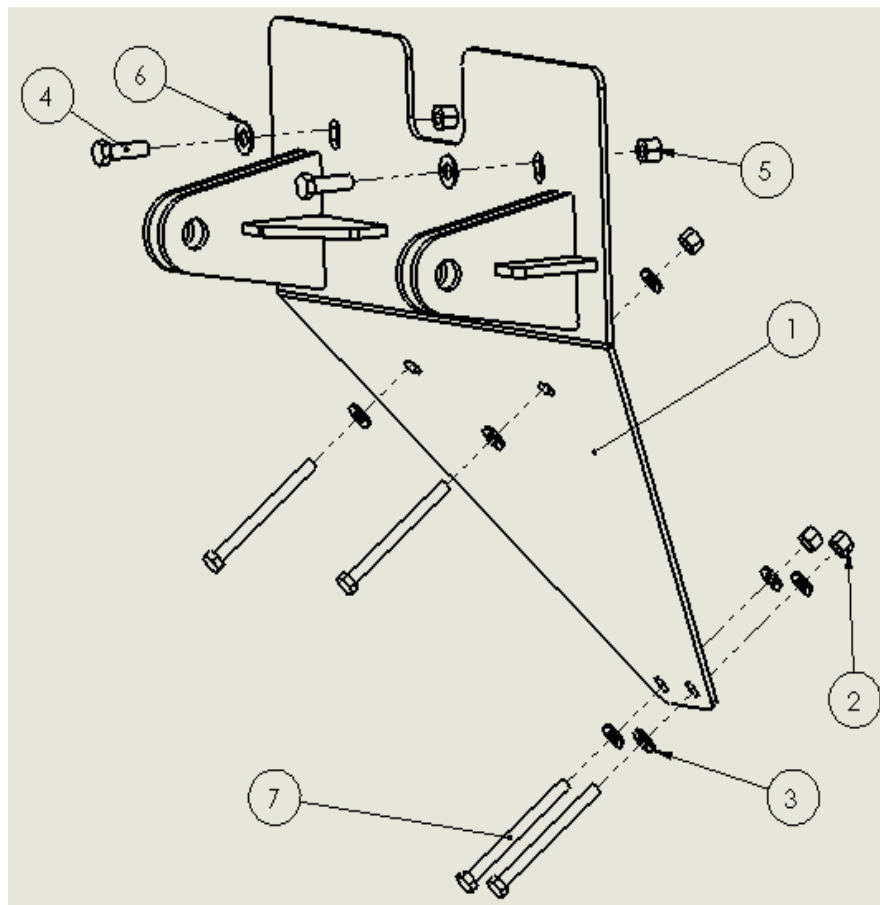

Figure 1

## CanAm Commander Installation Instructions

1. Hold the plow mount up to the bottom of the Commander with the smallest end facing toward the back of the vehicle. Use two of the 5/16" x 3 3/4" Bolts, Nylock nuts, and washers, to secure the back part to underbody of the Commander. Refer to the pictures (#1, 2, 3). Do not tighten the bolts at this time but tighten them enough that the mount is held close to the Commander underbody.



**Figure 1**



**Figure 2**



**Figure 3**

- Using a 3/8" drill bit, drill two holes through the front bumper sheet metal. Secure the front of the plow mount using the 3/8" x 1 1/4" bolts, washers, and Nylock nuts supplied. Picture #4 shows the reverse side of the front bumper where the 3/8" bolt holes will pass through



**Figure 4**

- Using a 5/16" drill bit, drill two holes through the rectangular front chassis. Secure the center of the plow using the remaining 5/16" x 3 3/4" bolts, washers and Nylock nuts. Picture #5 shows the reverse side of the front chassis where the two 5/16" bolts will pass through.

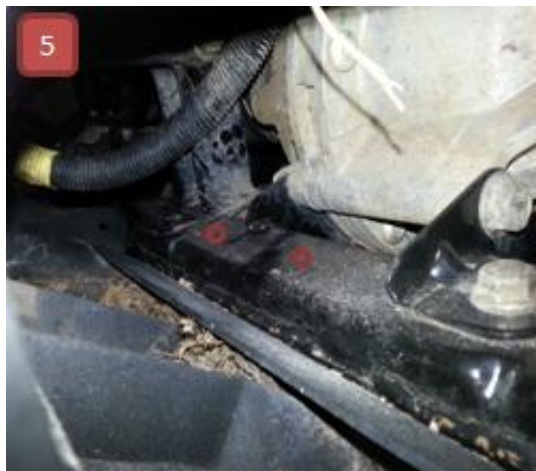

**Figure 5**

- Tighten all remaining bolts. After the first few uses it is good practice to ensure that all the bolts remain tight. Tighten if necessary.