



# '02-'07 Suzuki Eiger, '02-'07 Vinson

## Winch Mount

PART # 100555

### Kit Components:

Qty	Part Description
1.....	Winch Mount
4.....	5/16-18 x 1.00" HH Flanged Bolt
4.....	5/16" Nylock Nuts
4.....	5/16" SAE Flat Washers

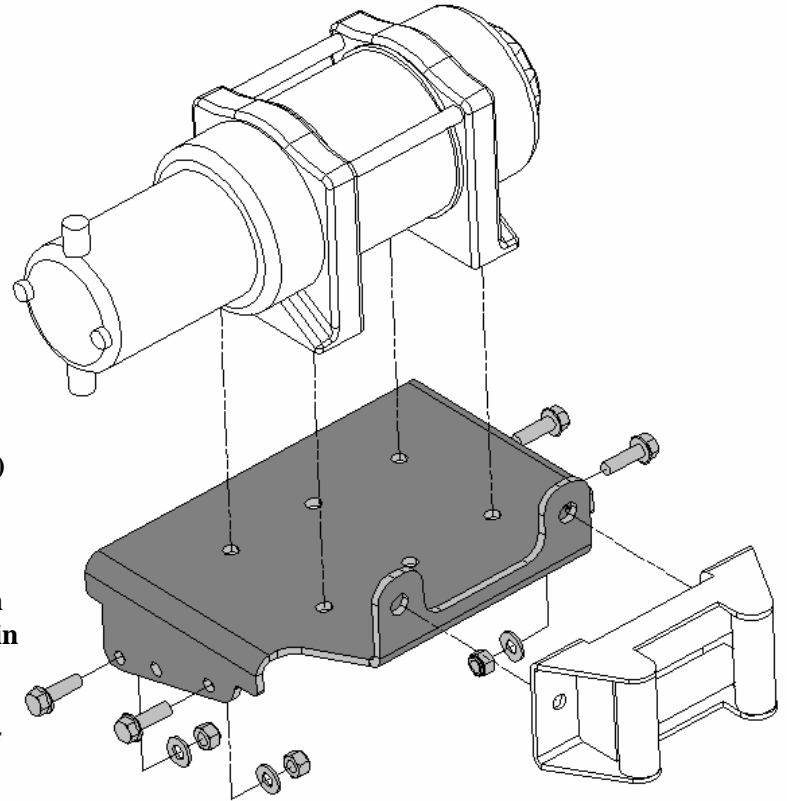

## INSTALLATION INSTRUCTIONS:

1. Begin by removing the front plastic fascia (A) that protects the front bumper assembly. See "Figure 1"
2. Place mounting plate into location and attach using the supplied 5/16" hardware as shown in "Figure 2".
  - For Vinson use (B1) and (B3) bolt locations
  - For Eiger use (B1) and (B2) bolt locations
3. Assemble your winch and the Fairlead to the mounting plate using the hardware that was supplied with your winch.
4. Re-install plastic fascia that was removed.
5. Using the instructions provided with your winch, wire accordingly.

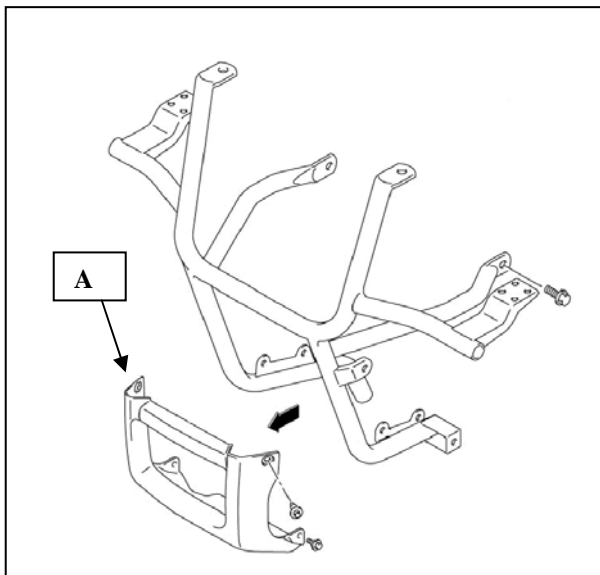

**Figure 1 Remove Plastic Fascia**  
(Vinson model shown, Eiger is similar)

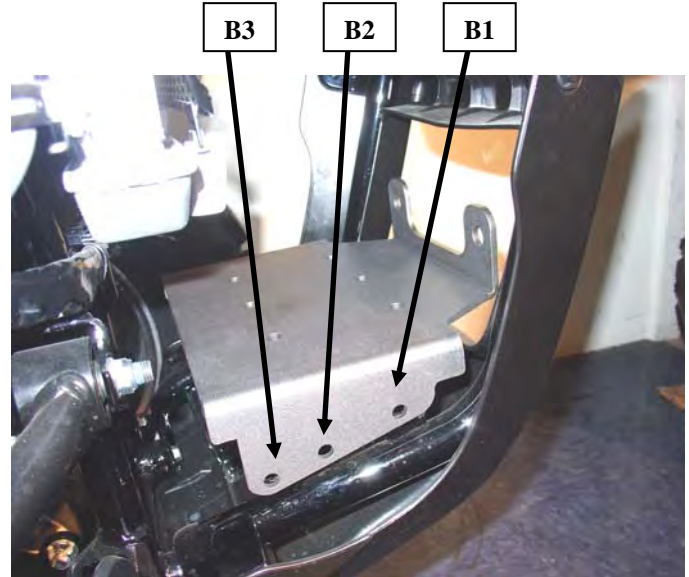

**Figure 2 Assemble Mounting Plate**  
(Vinson model shown, Eiger is similar)

