

# FAIRLEAD PLOW PULLEY (STANDARD/WIDE)

Pulley Bracket      Part # 105270, 105465  
Hardware Kit: HK-138

## Kit Components:

Qty.	Part Description
1.....	Pulley Bracket
2.....	Nylon Spacer
1.....	Nylon Bushing
1.....	KFI Pulley
1.....	3/8"-16 X 1 1/2" Carriage Bolt
1.....	3/8"-16 Nylock Flange Nut
2.....	3/8"-16 X 3/4" Bolt
2.....	3/8" Lock Washer
2.....	3/8"-16 Jam Nut
2.....	3/8" SAE Washer

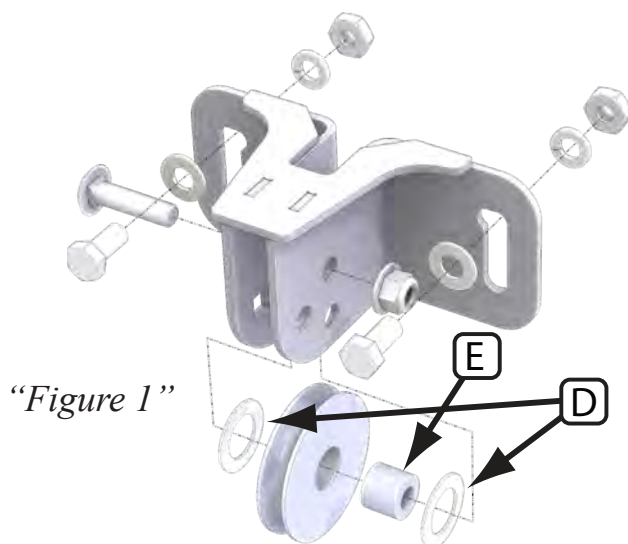

## INSTALLATION INSTRUCTIONS:

1. Place cable over pulley and decide if upper (A), lower (B) or forward (C) position is best for your winch.  
*Note: Keep in mind that your cable needs to clear your fairlead bracket.*
2. Install Nylon Spacers (D) and Nylon Bushing (E) to Pulley as shown in Figure 1.
3. Place cable over pulley and install to Pulley Bracket using the 1 1/2" Carriage Bolt and Flange Nut as shown in Figure 1.

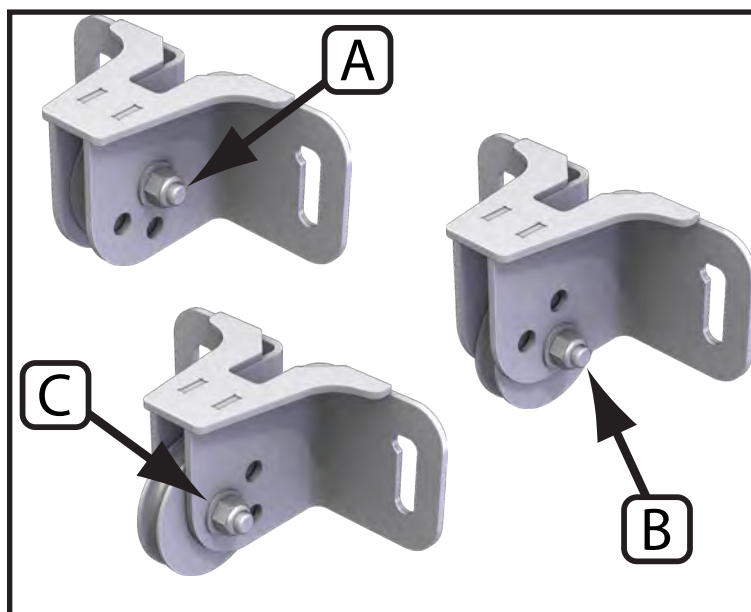

4. Loosely install 3/8" bolt, washer, lock washer and nut (F) through fair-lead bracket and pulley bracket as shown in Figure 1&3. Slots have been cut into the brackets to adjust for clearance of plastic on the machine.

*Note: You may also need to use the forward position (C) to clear the plastic.*

5. Once desired position is found tighten down all nuts.

*Note: Make sure the cable is as close to 90 degrees from the ground as you can get it. Most plows come with 3 or more hook points for winches that are offset from the center of the machine.*

