

BMW F900XR '20

REF 20388N

R19 CRASH PAD

INSTRUCTIONS TO ASSEMBLE

Remove the fasteners that subject the chassis to the engine. Mount the protectors on each own side as the figure below shows. Tight the set, and place the caps. All the screws replaced, should be tightened to the torque specified in the oem maintenance manual for your motorcycle. if no torque specifications are provided in the oem maintenance manual, may be used 54Nm for all M10 screws.

Medium strength liquid thread-locker (i.e. "Loctite") should be used to secure all screws, bolts and nuts. All screws, bolts and nuts should be checked after driving the first 50 km to ensure that all are tightened to the proper torque.

FOR TO ASSEMBLE THE CRASH PADS, IF YOU ARE NOT A TRAINED MECHANIC, PLEASE CONTACT A SPECIALIST. MOTOPLASTIC, S.A. TAKES NO RESPONSIBILITY FOR DAMAGES CAUSED BY IMPROPER INSTALLATION. THE USE OF CRASH PADS DO NOT GUARANTEE A FULL PROTECTION IN CASE OF ACCIDENT. MOTOPLASTIC-PUIG DECLINE ANY RESPONSIBILITY IN CASE OF MOTORCYCLE DAMAGE.

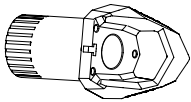
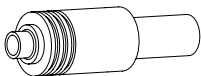
ID.	PART	DESCRIPTION	QTY.	REF.:
1		Covers set	2	TAPAPROTECR19-D/I
2		M12/170 DIN912 screw	2	M2TM12175170A9B
3		M12 DIN433 washer	2	ARANM12DIN433ZB
4		R19 Nylon protector 85mm	2	PROTECNLR19-165
5		Right spacer (Aluminum)	1	CASQU472-0-1772
6		Left spacer (Aluminum)	1	CASQU473-0-1773

BMW F900XR '20

REF
20388N

MOUNTING INSTRUCTIONS

1

ASSEMBLY

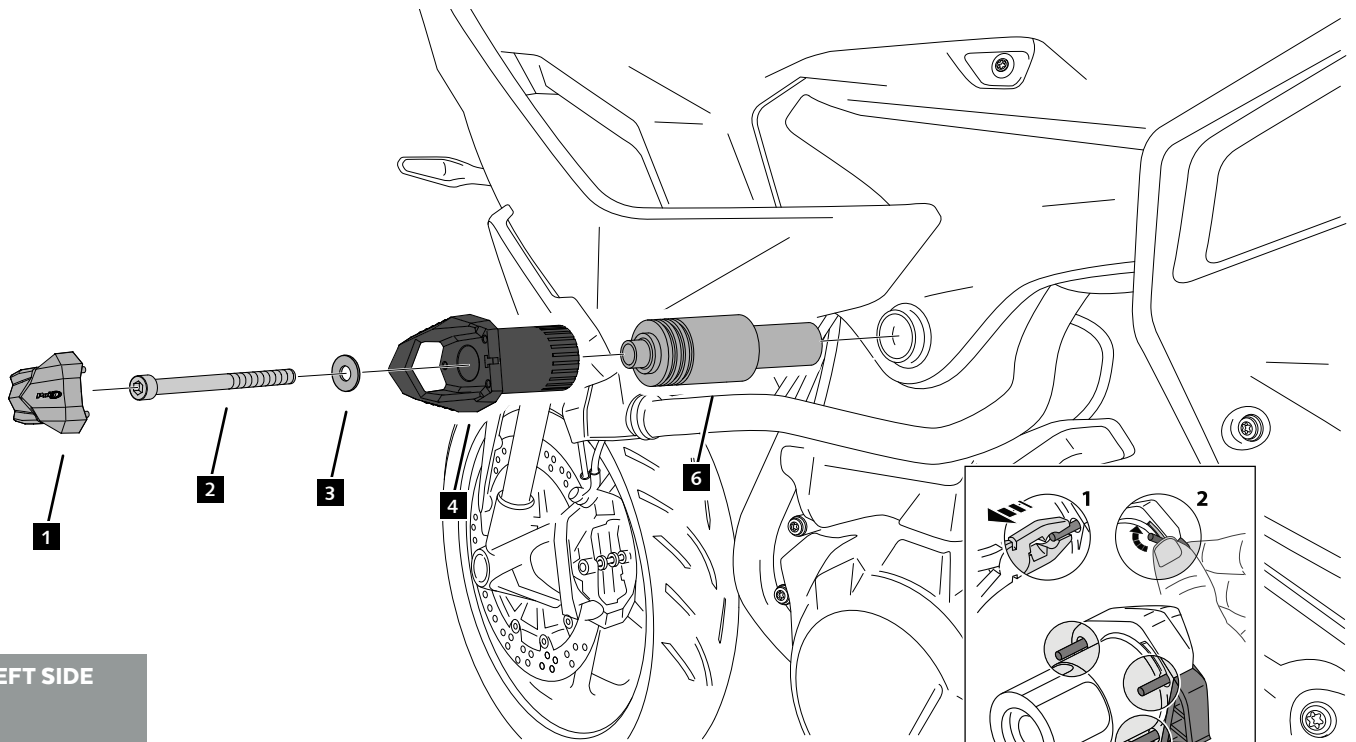

LEFT SIDE

2

ASSEMBLY

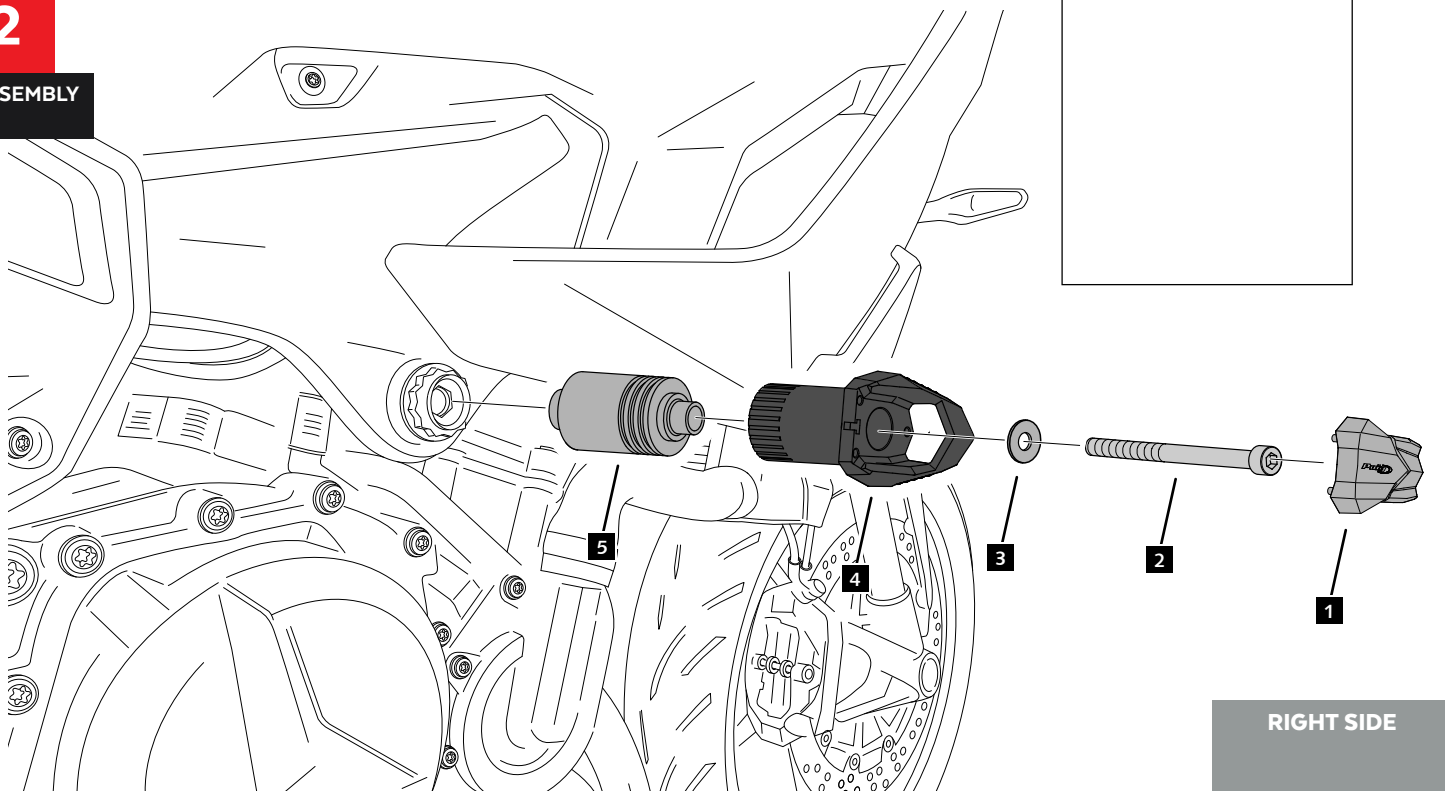

RIGHT SIDE