

Installation & Operations Manual for Side View Mirror

Contents:

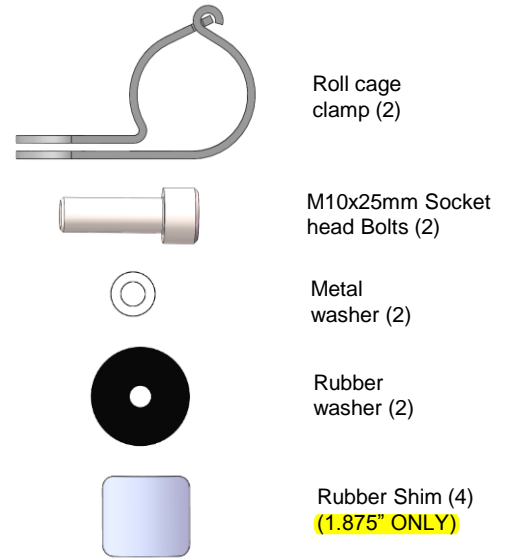
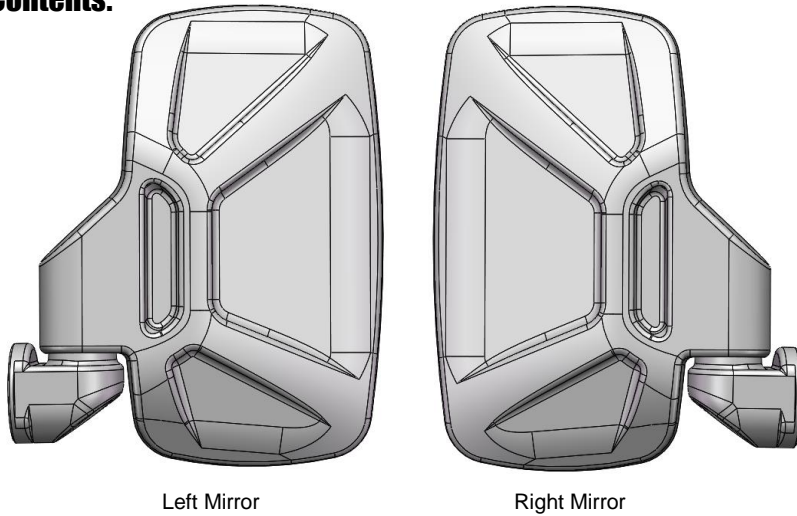

Installation:

1.

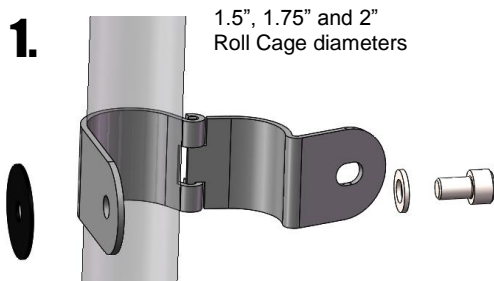

Open clamp and place around roll cage tube.
Do not use rubber shims for 1.5", 1.75" and 2" Roll Cage diameters.

Rubber Shim for 1.875" Diameter Roll Cage Only

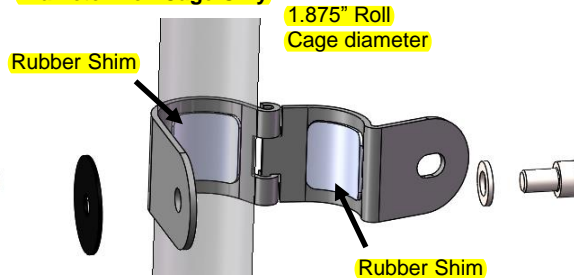

Open clamp and place around roll cage tube.
For the 1.875" Roll Cage only, use 2 rubber shims (one on each side of the clamp)

2.

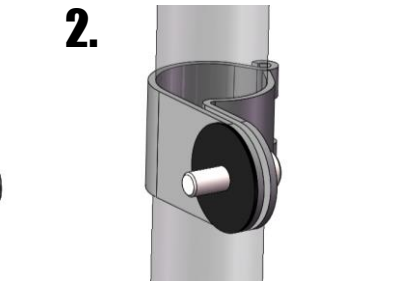

Close clamp around roll cage tube, put the bolt through the hole, and place large rubber washer over the end of the bolt.

3.

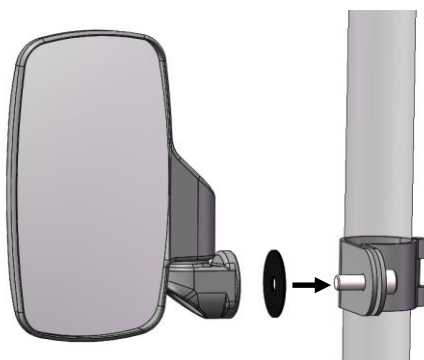

Screw the bolt into the mirror but do not tighten yet.

4.

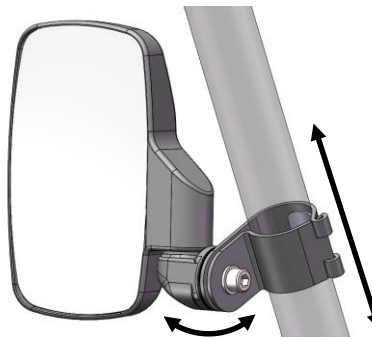

Slide mirror up or down Roll Cage tube to desired location. Rotate mirror on clamp to desired angle. When you are satisfied with the location and angle, tighten bolt.

5.

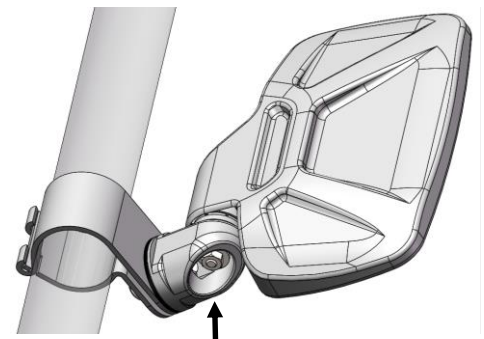

To tighten the folding feature of the mirror, tighten tension adjustment nut on the bottom of the mirror arm.