

YAMAHA RHINO CENTER WEDGE

Application: : (1) Bracket #60XXB for 2005-2006 Yamaha Rhino (Fig 1)
 (1) Bracket #60XXCB for 2007-2008 Yamaha Rhino (Fig. 2)

Part #: 6035 & 6045

FOR 6035 & 6045

- 1) Remove the (2) Center Roll Cage Bolts (Fig. 3)
(for 2006 & 2007 Rhino Remove Hex bolts in front)
- 2) Mount the Aluminum Bracket using the factory bolts or hex bolts from vehicle.
- 3) Place the Center Wedge on the Bracket. Using the (4) #10-23 screws with washers mount the Center Speaker Wedge: NOTE: Wires & Connector will slide into the groove on the bracket
- 4) Connect the wire harness to the back of the Wedge
- 5) Run Wire harness to desired location.
- 5) Connecting Speakers:
 Splice wires from the Wedge into the left and right speaker wires under the dash

Drivers Side - Left	Passenger Side - Right
Green / Red (+)	White /Red (+)
Green (-)	White (-)

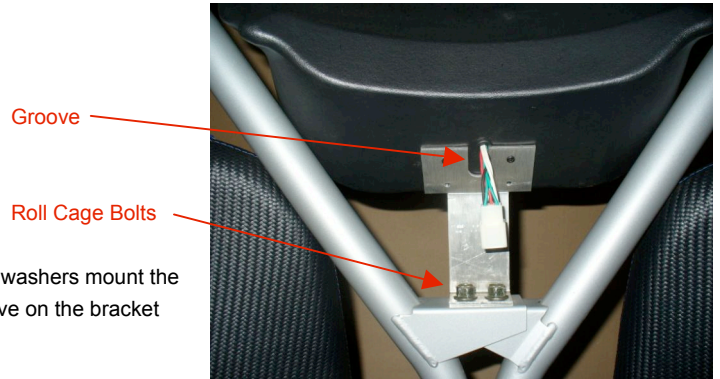

(Fig. 3) Shown Mounted on 05-06 Rhino

FOR 6045 with LED Light Show

NOTE: Not used for #6035

- 6) Connecting the Power for the LED Light Show
LED Light Show
 Red (+) Attach to Battery or Fuse
 Black (-) Attach to a good ground

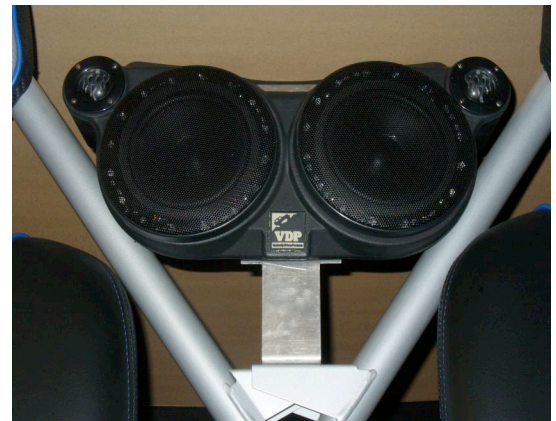

FRONT VIEW INSTALLED

RHINO BRACKETS



(Fig. 1)
 Part #60XXB
 2005-2006 Rhino



(Fig. 2)
 Part#60XXCB
 2007-Current Rhino



#10-32 Screws
 Lock Washers

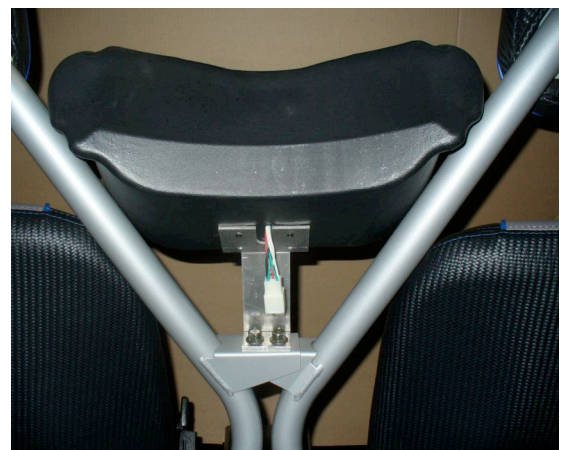

REAR VIEW INSTALLED