



VIPER Winch Mount

MA11904

Polaris Ranger

Thank you for purchasing our VIPER winch mount. You now own a premium custom winch mount which allows you to use your winch with your UTV / SxS. Please note the following instructions and heed all warnings:

- Please use common sense when operating your UTV / SxS
- Read your Winch Operator Manual and all other operator manuals, including warning labels, before operating your UTV / SxS
- Be observant of moving parts causing entanglement; use extreme caution!

SEVERE INJURY OR DEATH MAY RESULT IF YOU ARE NEGLIGENT.

**MA11904
Polaris Ranger Winch Mount**

Please verify that all hardware and parts are included in your package.

Kit Contents:

Item	Description	QTY
1	MA11904 Mount Plate	1
2	3/8" -16 x 1" Carriage Bolt	4
3	3/8" -16 x 1" Hex Head Bolt	2
4	3/8" Flat Washer	6
5	3/8"-16 Nylock Nut	4
6	MA11225 Wide-to-Narrow Spool Converter (not shown) (standard spool winches only)	1
7	3/8"-16 x 1 1/4" Grade 5 Hex Bolt (not shown) (Use with MA11225)	2
8	3/8" Flat Washer (not shown) (Use with MA11225)	2
9	3/8"-16 Nylock Nut (not shown) (Use with MA11225)	2
10	Metal Grill Replacement (not shown)	1

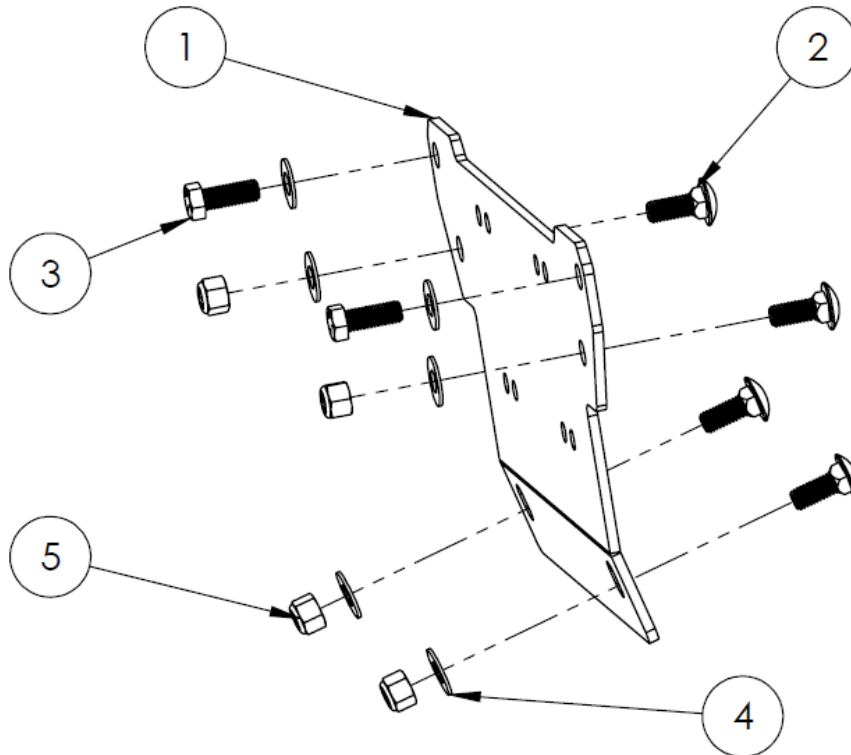

MA11904 Winch Mount Assembly View

**MA11904
Polaris Ranger Winch Mount**

Installation:

- 1) Completely remove the front bumper from the machine.
- 2) Remove the plastic grill from the bumper and replace it with the metal grill included in your kit.
- 3) If the winch is a Standard Spool winch (Bolt Pattern: 4 7/8" x 3"), use the MA11225 Wide-to-Narrow spool converter bracket. Attach the MA11225 bracket to the front bumper grill using the two (2) 3/8"-16 x 1 1/4" Grade 5 Hex Bolts. Then, attach the fairlead to the MA11225 bracket using the hardware in the winch kit.
- 4) If the winch is a Wide Spool winch (Bolt Pattern: 6.60" x 3"), attach your fairlead directly to the front bumper grill using the hardware included in your winch kit.
- 5) If the winch includes a Rubber Line Stopper, remove the steel cable or synthetic rope from the winch. Pass the cable through the Rubber Line Stopper and then through the Roller Fairlead or Aluminum Hawse and the bumper. Leave the cable unattached at this point. After the winch is fully installed, reattach the cable to the winch. Leave the cable unwound as it will need to be wound under load to properly set the cable.

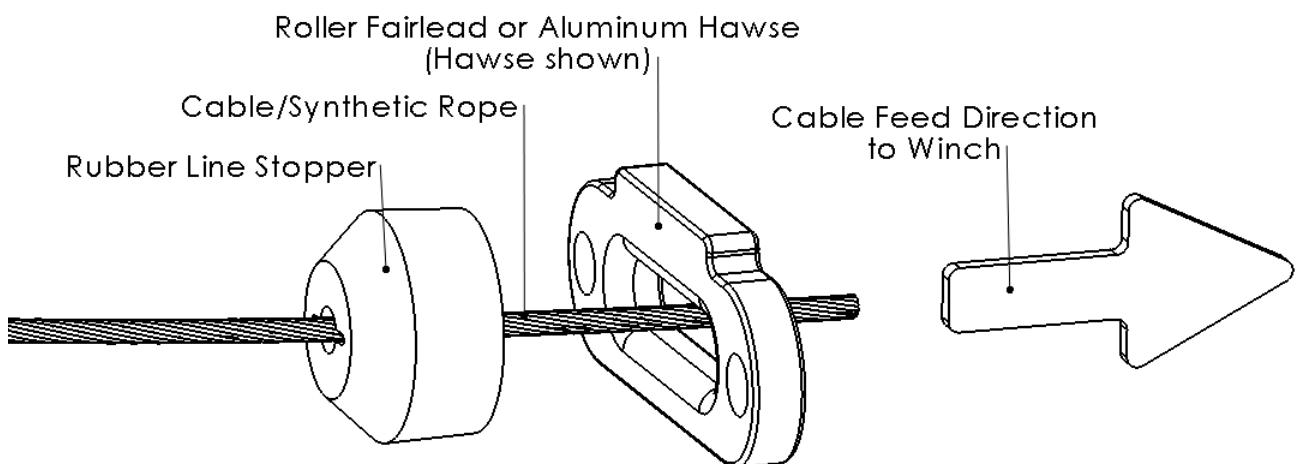

Figure 1

- 6) Attach the winch to the mount bracket such that the motor faces the drive side of the vehicle (Figure 2). The bend in the mount plate should angle toward the vehicle. Use the hardware included with your winch kit to secure the mount and winch.

**MA11904
Polaris Ranger Winch Mount**



Figure 2

- 7) Attach the winch & mount to the XP900 using the 3/8" hardware included in the kit. See (MA11904 Assembly View and Figure 2) as a bolt pattern guide. Attach the top bolts first, but do not tighten them down at this time. Attach the bottom two carriage bolts (note the direction of the bolts in Figure 1). Lastly, install one carriage bolt on the motor side of the winch. The gear side may be too close to the mount for a second bolt to attach.
- 8) Reattach the winch cable to the winch. Make sure that it is running over the top of the spool and between the tie rods as shown in Figure 2.
- 9) Reinstall the front bumper.
- 10) Mount the contactor under the hood of the machine and wire up according to the winch manual. It may be necessary to swap the longer blue and yellow wires with the shorter black and red wires on some machines.
- 11) Once the winch is wired up properly, tie the end of the cable off to a secure location (such as a tree, a post, or a full sized truck), set the brake on the machine and wind the winch in carefully (following the duty cycle noted in your winch operations manual), watching to make sure the cable doesn't become tangled. This will help set the cable and prevent future tangles.