



***motoalliance***

# **MOTOALLIANCE WINCH MOUNT**

## **MA11955**

### **CFMOTO C-Force**

**Thank you for purchasing our MotoAlliance winch mount. You now own a premium custom winch mount allowing you to use your winch with your ATV / SxS. Please note the following instructions and heed all warnings.**

- **Please use common sense when operating your ATV / SxS**
- **Read your Winch Operator's Manual and all other Operator Manuals including warning labels, before operating your ATV / SxS**
- **Be observant of moving parts causing entanglement use extreme caution!**

**SEVERE INJURY OR DEATH MAY RESULT IF YOU ARE NEGLIGENT.**

Please verify that all hardware and parts are included in your package.

**Kit Content:**

Item Number	Description	Quantity
1	MA11955-1 Main Bracket	1
2	MA11955-3 Winch Spacer	4
3	MA11955-2 Mount Spacer	2
4	3/8"-16 x 1" Serrated Flange Bolt	4
5	3/8"-16 Serrated Flange Nut	4
6	M8 Split Lock Washer	4
7	M8-1.25 x 30mm Hex Head Bolt	4

**Exploded View**

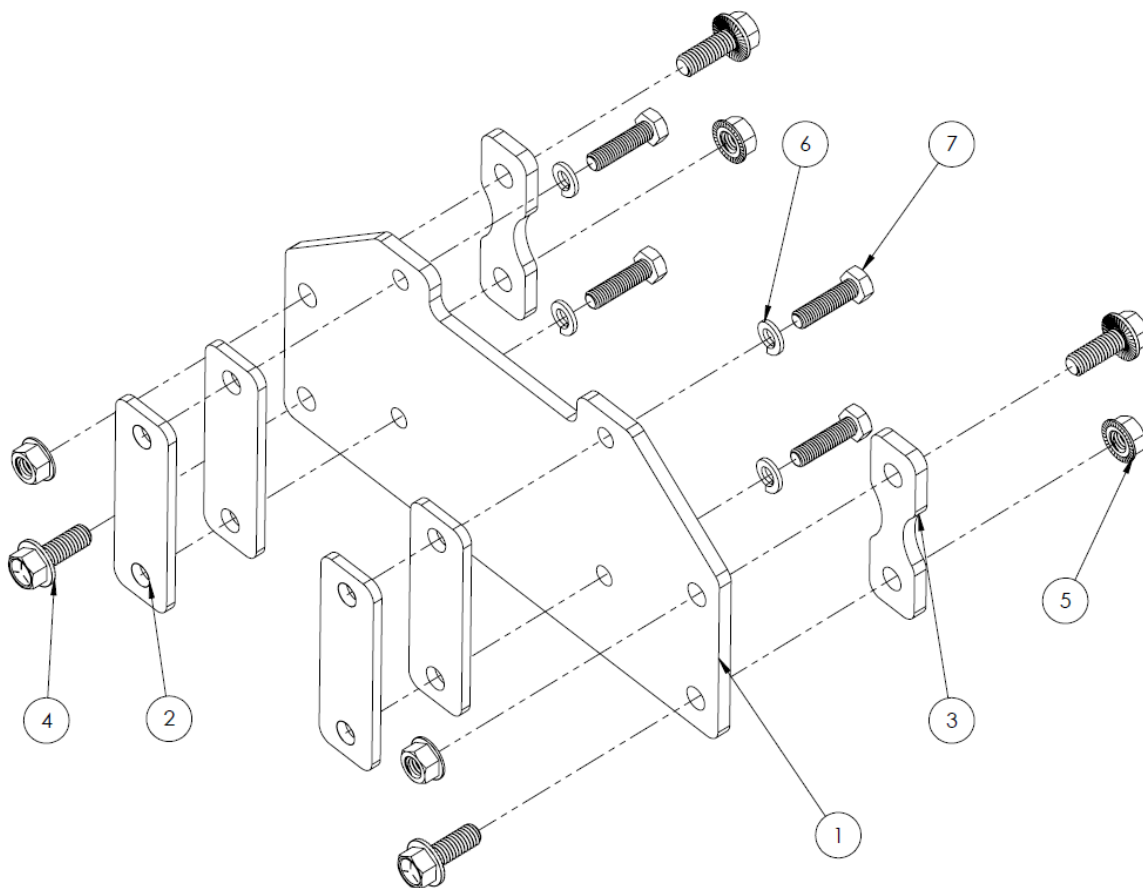

**Figure 1**

1. Remove the four bolts that hold the front fascia to the bumper as shown in Fig 2.



**Figure 2**

2. Once the cavity behind the bumper is accessible set all hardware aside to be reinstalled later.
3. If the winch includes a Rubber Line Stopper, remove the steel cable or synthetic rope from the winch. Pass the cable through the Rubber Line Stopper and then through the Roller Fairlead or Aluminum Hawse and the bumper. Leave the cable unattached at this point. See Figure 3

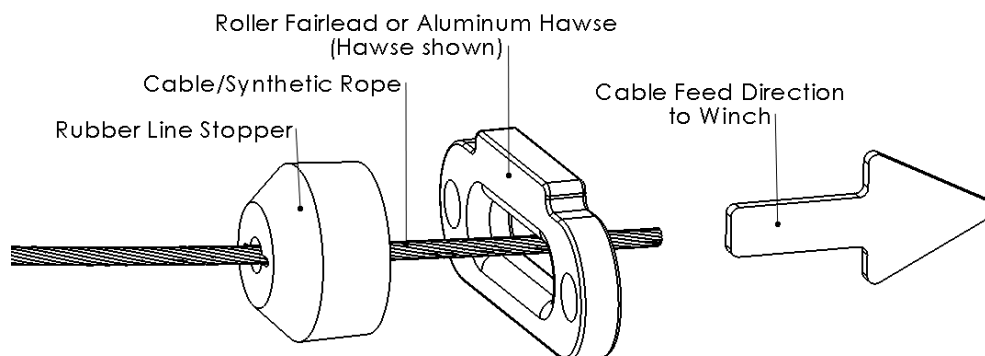

**Figure 3**

4. Attach the winch to the MA11955-1 Main Mounting Plate using the provided M8 hardware and the MA11955-3 Winch Mounting Spacers as shown in Figure 4.

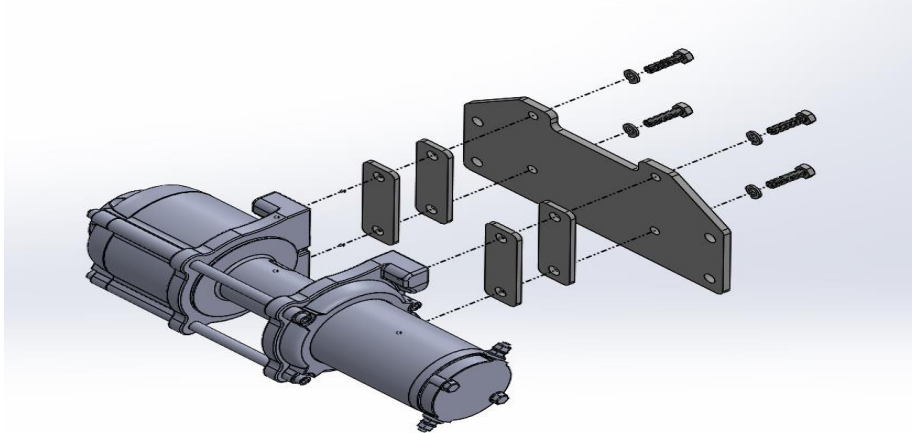

**Figure 4**

5. Slide the winch and mount inside the bumper cavity and align the outer holes on the winch mount with the available mounting holes on the machine.
6. Place the MA11955-2 Mount Spacers between the MA11955-1 Main Mount Plate and the mounting holes on the machine and secure using the provided 3/8" hardware as shown in Figure 5. Note the hardware orientation in Figure 5.

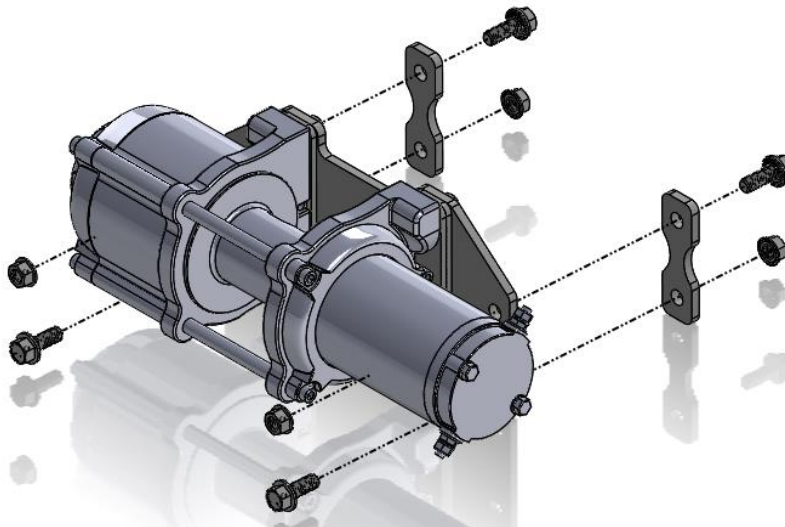

**Figure 5**

- 
7. After the winch is fully installed, reattach the cable to the winch. Leave the cable unwound as it will be wound under load to properly set the cable.
  8. Reinstall the bumper fascia removed in Step 1.
  9. Mount the contactor in a protected location near the battery and wire up according to the winch manual.
  10. Once the winch is wired up properly, secure the end of the cable to a fixed mounting point (such as a tree, a post, or a full sized truck), set the brake on the machine and wind the winch in carefully (following the duty cycle noted in your winch operations manual). Make sure the cable doesn't become tangled during recovery. This will help set the cable and prevent future tangles.