



INSTALLATION INSTRUCTIONS

WINCH MOUNTING KIT

Part Number: 90459

Application: 2012 Polaris Ranger HD
3,000 lb. or 3,500 lb. Winches

Your safety, and the safety of others, is very important. To help you make informed decisions about safety, we have provided installation and operating instructions and other information on labels and in this guide. This information alerts you to potential hazards that could hurt you or others. It is not possible to warn you about all potential hazards associated with this product, you must use your own good judgment.

CARELESS INSTALLATION AND OPERATION CAN RESULT IN SERIOUS INJURY OR EQUIPMENT DAMAGE. READ AND UNDERSTAND ALL SAFETY PRECAUTIONS AND OPERATING INSTRUCTIONS BEFORE INSTALLING AND OPERATING THIS PRODUCT.

This guide identifies potential hazards and has important safety messages that help you and others avoid personal injury or death.

WARNING and **CAUTION** are signal words that identify the level of hazard. These signal words mean:

WARNING signals a hazard that *could* cause serious injury or death, if you do not follow recommendations. **CAUTION** signals a hazard that *may* cause minor to moderate injury, if you do not follow recommendations.

This guide uses **NOTICE** to call attention to important mechanical information, and **Note**: to emphasize general information worthy of special attention.

WARNING

INJURY HAZARD

Failure to observe these instructions could lead to severe injury or death.

- ☐ **Always** use extreme caution when drilling on any vehicle. Make sure that all fuel lines, brake lines, electrical wires, and other objects are not punctured or damaged when / if drilling on the vehicle. Thoroughly inspect the area to be drilled (on both sides of material) prior to drilling, and relocate any objects that may be damaged. Failure to inspect the area to be drilled may result in vehicle damage, electrical shock, fire or personal injury.
- ☐ **Always** wear safety glasses when installing this kit. A drilling operation will cause flying metal chips. Flying chips can cause eye injury.
- ☐ **Always** use extreme caution when cutting and trimming during fitting.
- ☐ **Always** remove jewelry and wear eye protection.
- ☐ **Never** lean over battery while making connections.
- ☐ **Never route electrical cables:**
 - Across any sharp edges.
 - Through or near moving parts.
 - Near parts that become hot.
- ☐ **Always** insulate and protect all exposed wiring and electrical terminals.
- ☐ **Always** install terminal boots as directed in installation instructions.
- ☐ **Always** use appropriate and adequate care in lifting components into place.
- ☐ **Always** insure components will remain secure during installation and operation.
- ☐ **Always** tighten all nuts and bolts securely, per the installation and operation.
- ☐ **Always** perform regular inspections and maintenance on the winch, winch mount and related hardware.
- ☐ **Never** operate this **WARN** product with damaged or missing parts.

 Caution
Moving Parts Entanglement Hazard
Failure to observe these instructions could lead to minor or moderate injury.
<input type="checkbox"/> Always take time to fully read and understand the installation and Operations Guide included with this product. <input type="checkbox"/> Never operate this product if you are under 16 years of age. <input type="checkbox"/> Never operate this product when under the influence of drugs, alcohol or medications.
Read installation and operating instructions thoroughly.

Notice
Equipment Damage
<input type="checkbox"/> Always refer to the Installation and Specification Guide, supplied in the winch kit, for all wiring schematics and specific details on how to wire this WARN product to your vehicle.
Read installation and operating instructions thoroughly.

I. BEFORE YOU BEGIN

Before you begin disconnect the positive battery lead from the battery.

II. TABLE OF CONTENTS

Torque Specifications	page 2
Tools Required	page 2
Parts List	page 3
Installation	page 4-6
Maintenance/Care	page 7

III. TORQUE SPECIFICATIONS

1/4, 6MM	8 lb. ft. (10.8 N-m)
5/16, 8MM	17 lb. ft. (12.5 N-m)
3/8, 10MM	30 lb. ft. (40.7 N-m)
7/16, 11MM	50 lb. ft. (67.8 N-m)
1/2, 12MM	75 lb. ft. (101.7 N-m)

IV. TOOLS REQUIRED

- 13mm, 14mm, 15mm, 18mm Socket
- #27 Torx screwdriver
- 10mm, 16mm, 17mm wrench
- Socket Driver

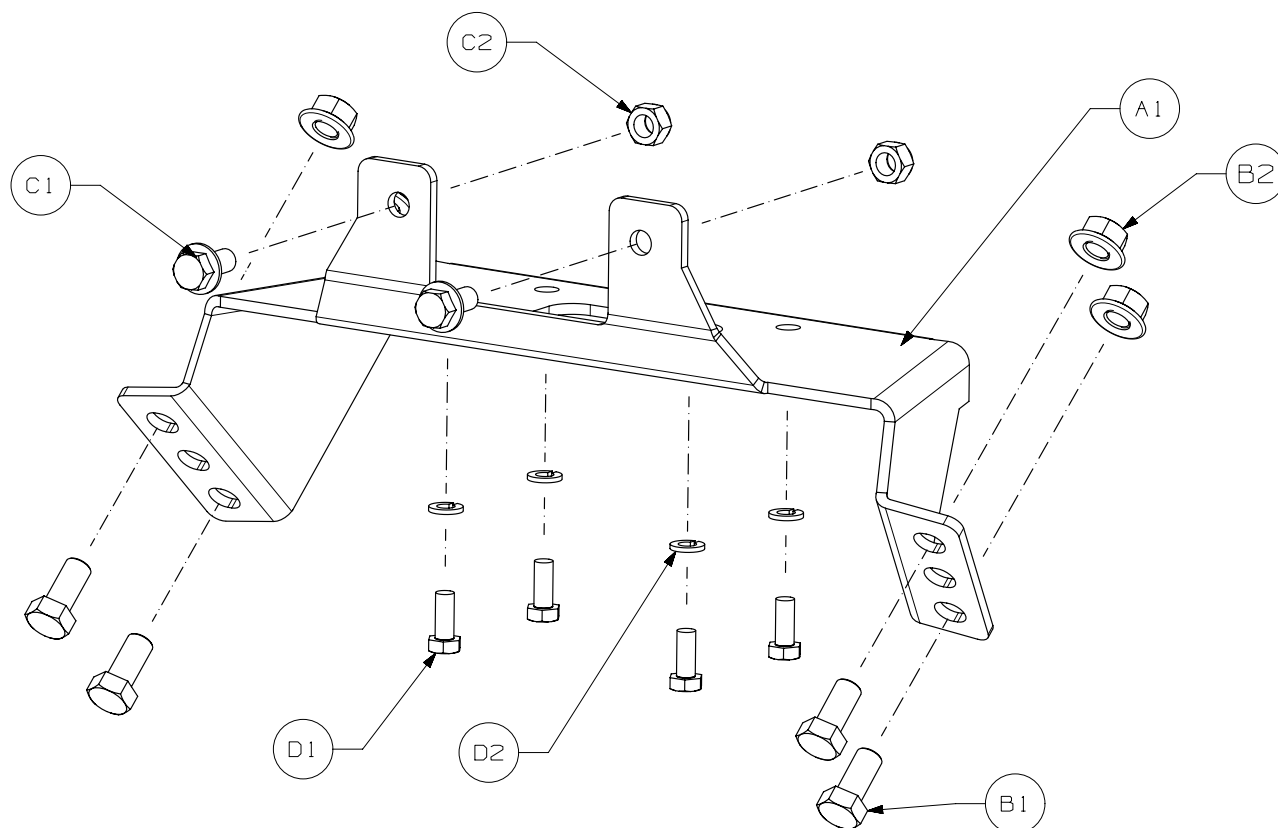

V. PARTS LIST

<u>No.</u>	<u>Part Number</u>	<u>Qty</u>	<u>Description</u>
A1	80373	1	Brkt, Winch Polaris Ranger MY09
B1	79464	4	M12x1.75x25mm Hex Flangehead Capscrew
B2	79465	4	M12x1.75 Hex Flange Nut with insert
C1	79461	2	M10x1.25x20mm Hex Flangehead Capscrew
C2	79463	2	M10x1.25 Hex Nut with insert
D1	34402	4	M8x1.25x20mm Hexhead Capscrew
D2	1402	4	5/16 Lock Washer

VI. INSTALLATION

1. Remove top and middle grille plates from vehicle, as shown in Figure 1, using a #27 Torx screwdriver to loosen the hardware. Use a 13mm socket to remove the bottom bumper mounting hardware. Keep all hardware for re-assembly later.

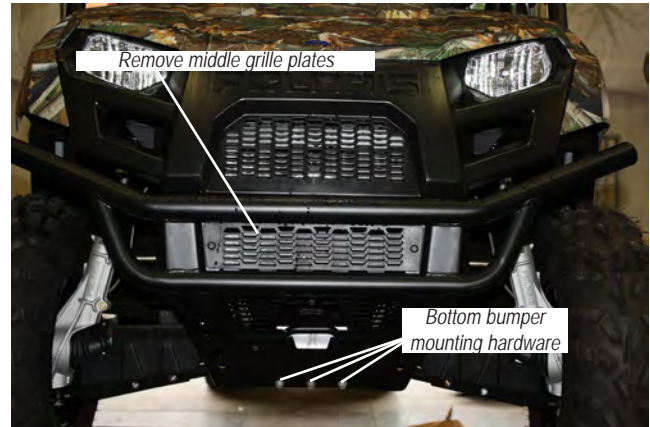

Figure 1

2. On back side of bumper, use a 15mm socket to remove the top mounting hardware on each side, as shown in Figure 2. Front bumper assembly can now be removed from vehicle.

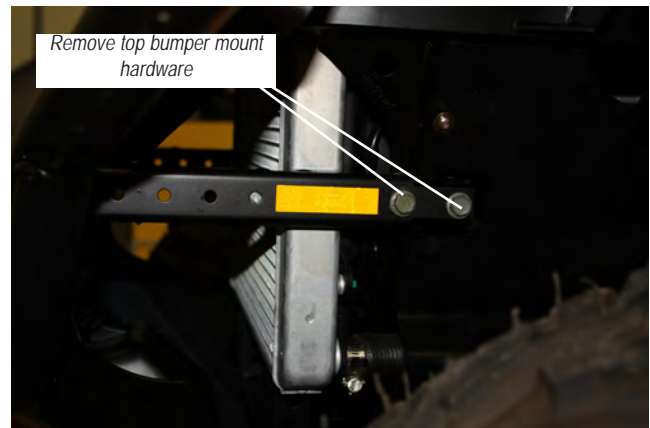

Figure 2

3. Mount RT/XT 40 winch to mounting bracket using four M8 x 1.25 x 20 mm capscrews and 5/16" lockwashers in hardware kit, as shown in Figure 3. Use a 13mm socket to tighten in place and torque to 17 lb. ft. (12.5N-m).



Figure 3

INSTALLATION CONT.

4. Mount the winch assembly to the front bumper, as shown in Figure 4, using four M12 x 1.75 x 25mm flangehead capscrews and flange nuts provided in the hardware kit. Use a 16mm wrench and 18mm socket to loosely secure in place at this time. Remount the bumper to vehicle in reverse procedure using hardware previously removed and tighten hardware hand tight at this time.

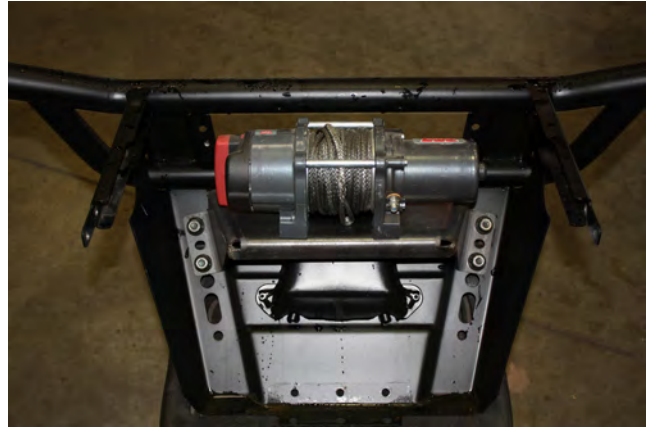

Figure 4

5. Tighten and torque all hardware in place, according to torque specification on page 2. As shown in Figure 6, fairlead mounting tabs are visible on front of bumper. Route winch cable through bumper and fairlead. Install fairlead using two M10 x 1.25 x 20mm flange head capscrews and hex nuts. A 14mm socket and 17mm wrench can be used to tighten in place. Torque to 30 lb. ft. (40.7 N-m). Finally, install hook and strap.



Figure 5

6. Using original tow drive hardware, you may modify middle grill plate and re-install or leave it off if you prefer. Figure 6 shows final installation.



Figure 6

INSTALLATION CONT.

WARNING

READ THE VEHICLE'S OPERATOR MANUAL, WINCH OPERATOR MANUAL, AND ALL WARNING LABELS PRIOR TO OPERATION OF UTV AND WINCH.

THE WINCH MOUNTING PLATE INSTALLATION IS NOW COMPLETE.

- **Wire winch according to instructions found in winch kit.**

PROCEED TO SECTION TITLED "MAINTENANCE/CARE".

WARNING

FAILURE TO SECURELY TIGHTEN ALL BOLTS ON THE WINCH PLATE, WINCH, AND FAIRLEAD CAN RESULT IN PRODUCT FAILURE WHICH MAY RESULT IN VEHICLE DAMAGE AND OPERATOR INJURY OR DEATH. DOUBLE CHECK THAT ALL BOLTS ARE SECURELY TIGHTENED PRIOR TO USE.

VII. MAINTENANCE/CARE

- 1. Inspect all parts on the winch, winch mount, and related hardware prior to each use. Replace all hardware that appears rusted or deformed.**
- 2. Inspect all nuts and bolts on the winch, winch mount, and related hardware prior to each use. Tighten all nuts that appear to be loose. Stripped, fractured, or bent bolts or nuts need to be replaced.**
- 3. Check all cables prior to use. Replace cables that look worn or frayed.**
- 4. Check all moving or rotating parts. Remove debris that may inhibit the part from moving freely.**

WARNING

PERFORM REGULAR INSPECTIONS ON THE WINCH, WINCH MOUNT, AND RELATED HARDWARE. NEVER OPERATE THE WINCH WITH DAMAGED OR MISSING PARTS. FAILURE TO FOLLOW THIS WARNING MAY CAUSE VEHICLE DAMAGE AND OPERATOR INJURY OR DEATH.